

GROUND FLOOR
35.4 sq.m. (381 sq.ft.) approx.

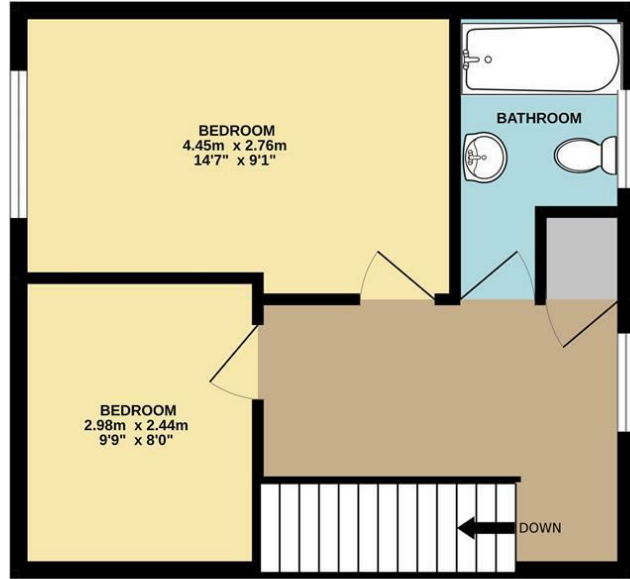

1ST FLOOR
35.4 sq.m. (381 sq.ft.) approx.



TOTAL FLOOR AREA : 70.7 sq.m. (761 sq.ft.) approx.

Whilst every attempt has been made to ensure the accuracy of the floorplan contained here, measurements of doors, windows, rooms and any other items are approximate and no responsibility is taken for any error, omission or mis-statement. This plan is for illustrative purposes only and should be used as such by any prospective purchaser. The services, systems and appliances shown have not been tested and no guarantee as to their operability or efficiency can be given.
Made with Metropix ©2022

Energy Efficiency Rating		Current	Potential
Very energy efficient - lower running costs			
(92 plus) A			92
(81-91) B		79	
(69-80) C			
(55-68) D			
(39-54) E			
(21-38) F			
(1-20) G			
Not energy efficient - higher running costs			
England & Wales		EU Directive 2002/91/EC	

Disclaimer – In accordance with the Property Misdescriptions Act, the company gives notice that all descriptions, references to condition, necessary permissions for use and other details are given in good faith and believed to be correct, but any intending lessees do not rely on them as statements of fact, but must satisfy themselves by inspection or other means, as to their accuracy.



Eldon Court | Attleborough | NR17
Guide Price £240,000



abbotFox presents this modern, two bedroom semi-detached house. Situated within a quiet close, within easy reach of Attleborough Town Centre, a variety of local amenities and the A11, this is an ideal opportunity for any buy-to-let investor or first time buyer. Accommodation comprises; inviting entrance hall, cloakroom, lounge and kitchen diner to the ground floor, with two double bedrooms and a family bathroom to the first floor. Externally, this home offers a private enclosed rear garden, driveway parking to the front and a garage. An internal viewing comes highly recommended to appreciate this home.

Guide price £240,000 - £250,000

